



Stainless Steel Drain Valve

Features

- Compact
- Finger Tighten
- 316 Stainless Steel
- 4000 PSIG Rating
- 1/8" and 1/4" Male Connections to Fit All of Our Housings

Applications

- Drain
- Vent
- Bleeder Valve

Our stainless steel drain valves offer a simple and reliable method to either drain liquids from a filter housing or vent to reduce the pressure before servicing an element. The knurled knob allows finger tightening of the unit; no tools are required once installed. The SSDV-1/4" is ideally used with our stainless steel series of housings. For further details and options please consult us at 1-800-311-5561.

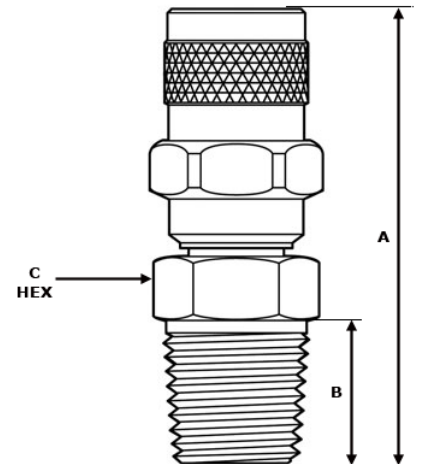

| End Connection | | Dimensions | | |
|----------------|------------|--------------|--------------|------|
| Type | Inlet Size | A | B | C |
| | | Inches (mm) | | |
| | | Hex Size | | |
| SSDV-1/8" | 1/8" | 1.62 (41.15) | 0.38 (9.65) | 5/8" |
| SSDV-1/4" | 1/4" | 1.81 (45.97) | 0.56 (14.22) | 5/8" |

